

EXHIBIT A

SOUTHEAST 106TH STREET RIGHT OF WAY VACATION LEGAL DESCRIPTION

THAT PORTION OF THE SOUTHEAST 106TH STREET RIGHT OF WAY IN THE SOUTHWEST QUARTER OF SECTION 4, AND THE SOUTHEAST QUARTER OF THE SOUTHEAST QUARTER OF SECTION 5, ALL IN TOWNSHIP 23 NORTH, RANGE 8 EAST, W.M., KING COUNTY WASHINGTON, AND LYING NORTHERLY OF THE NORTH RIGHT OF WAY MARGIN OF NORTHWEST 8TH STREET (FORMERLY KNOWN AS W.F. GARDNER COUNTY ROAD No. 635), BEING A LINE 20.00 FEET NORTH OF THE SOUTH LINE OF SAID SECTION 4, AND LYING SOUTHEASTERLY OF A LINE MORE PARTICULARLY DESCRIBED AS FOLLOWS:

COMMENCING AT THE SOUTHWEST CORNER OF SAID SECTION 4, BEING AND ENCASED 5/8 INCH BRASS PLUG WITH PUNCH, 0.6 FEET BELOW GRADE, IN THE CENTERLINE OF NORTHWEST 8TH STREET;

THENCE NORTH 03°29'02" EAST, ALONG THE WEST LINE OF SAID SECTION 4, FOR 614.70 FEET TO THE SOUTHWESTERLY RIGHT OF WAY MARGIN OF SOUTHEAST 106TH STREET;

THENCE NORTH 54°20'03" WEST, ALONG SAID MARGIN, FOR 28.23 FEET TO THE NORTHERLY MOST CORNER OF PARCEL B OF BOUNDARY LINE ADJUSTMENT No. PLN 2023-0446, FILED UNDER KING COUNTY RECORDING No. 20240516900011, AND BEING THE **POINT OF BEGINNING**;

THENCE NORTH 35°36'50" EAST, 60.00 FEET TO THE NORTHEASTERLY RIGHT OF WAY MARGIN OF SOUTHEAST 106TH PLACE, BEING THE **TERMINUS** OF THIS DESCRIBED LINE.

CONTAINING 65,313 SQUARE FEET, MORE OR LESS.

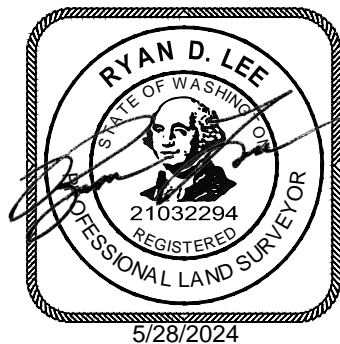

23086 – 90 NB INVESTMENTS, LLC
23086L.002.DOC – RDL
MAY 28, 2024

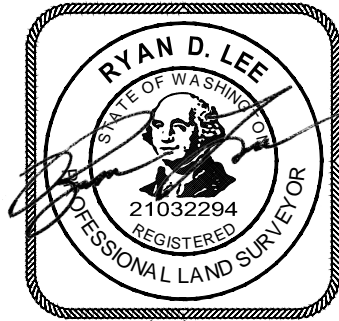

P:\23000s\23086\survey\23086-EXH02-ROW VACATION.dwg 3/15/2024 1:27 PM RLEE